



[www.gracobaby.com](http://www.gracobaby.com)

# TURBOBOOSTER LX

BOOSTER SEAT

Read This Instruction Manual

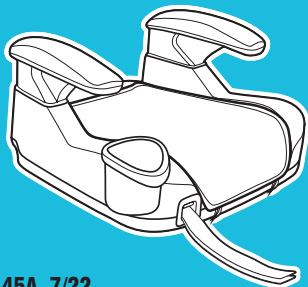

**Do not install or use  
this child restraint until you read  
and understand the instructions in  
this manual.**

**FAILURE TO PROPERLY USE THIS  
CHILD RESTRAINT INCREASES  
THE RISK OF SERIOUS INJURY  
OR DEATH IN A SUDDEN STOP OR  
CRASH.**

NWL0001453445A 7/22

# 1 Important

*Pages 5-16*

**1-A Quick Guide to Your Manual**

**1-B Welcome to the Graco Family**

**1-C Before You Begin**

Register This Child Restraint

If You Need Help

Certification

Car Seat's Useful Life

Vehicle Seat Protection

Warm Weather Use

**1-D Safety Warnings**

# 2 Features

*Pages 17-18*

**2-A Car Seat Features**

## **3 Booster**

*Pages 19-23*

**3-A Booster Use**

**3-B Install Backless Booster**

## **4 Securing Child**

*Pages 24-29*

**4-A Securing Child Backless Booster**

## **5 Accessories**

*Page 30*

## **6 Vehicle Information**

*Pages 31-35*

- 6-A How to Remove Lower Anchor Connectors**
- 6-B Choosing Vehicle Seat Location**
- 6-C Unsafe Vehicle Seat Location**
- 6-D Vehicle Seat Belts**

## **7 Care & Cleaning**

*Pages 36-37*

- 7-A Cleaning Seat Pad**
- 7-B Cleaning Lower Anchor Straps**

# 1-A Quick Guide to Your Manual

This car seat is for children: **40-100 lb (18.1-45 kg) 43-57 in.**  
**(110.1-145 cm) at least 4 years old**

## *Car Seat Assembly (On Select Models)*

### **Adult Assembly Required**

#### **1. Attach Armrests**

To attach armrests to base, press armrests into opening in base.

**CHECK** to make sure armrests are securely attached by pulling up on them.

#### **2. Cupholder**

CUPHOLDER MUST BE INSTALLED.

Remove cupholder from compartment in bottom of base.

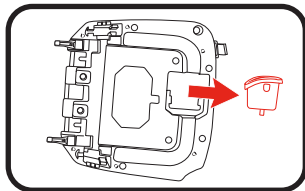
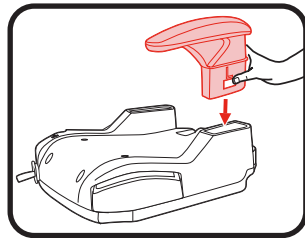

**i**  
1 Important

**1 Important**

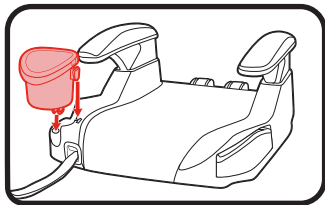

Align tabs on side and bottom of cupholder with their slots in base and press cupholder into place.  
**DO NOT REMOVE CUPHOLDER ONCE IT IS ATTACHED.**

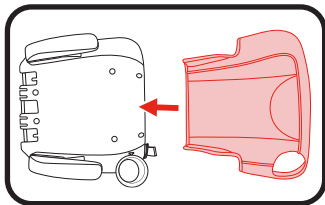

**3. Seat Pad**

Wrap seat pad around front of base and attach with elastic straps as shown.

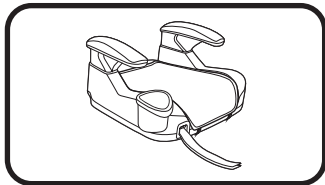
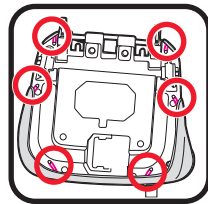

Your Graco booster seat is now ready to use.

## ***Get to Know Your Car Seat***

Review section 2-A to see all of the features of this booster seat.

## ***What Seating Location Should I Use?***

***The best seating location for this booster seat is one that:***

- Is recommended by your vehicle owner's manual, and
- Results in a secure installation of this booster seat.

Some vehicles have specific requirements for where the booster seat can be installed, so be sure to check your vehicle owner's manual for available seating positions, if any. For example, sometimes the center rear seat has a lap belt only vehicle seat belt, which cannot be used with this booster seat.

Review section 6-B, 6-C, 6-D of this manual AND your vehicle owner's manual.

**According to accident statistics, the safest place for your child in any vehicle is the back seat. The center of the back seat can be the safest during a possible side impact.**



## Using The Car Seat Correctly

To make sure your child is secured properly, review section 3 and 4 to fit your child.

### When Installing As a Booster

#### Lower Anchor System

The lower anchor system consists of lower anchor bars, which are built-in to your vehicle, and lower anchor connectors that are built-in your car seat.

Review section 3 of this manual AND your vehicle owner's manual.

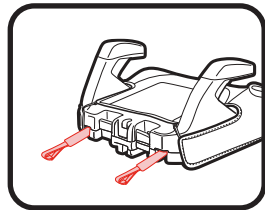
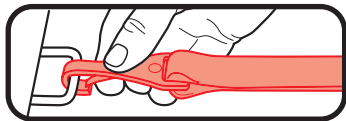

#### Vehicle Seat Belt

There is one type of vehicle seat belt that can be used: Lap/Shoulder Seat Belt.

Review section 3 of this manual AND your vehicle owner's manual.

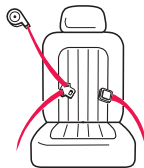



## ***Booster Installation***

### **Use Lap/Shoulder Belt Only**

Review section 3

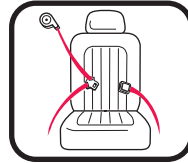

### **Position Lap Belt**

Lap belt must go in front of armrest and lie low across your child's hips and thighs.

Review section 4



### **Position Shoulder Belt**

Shoulder belt lies across shoulder between neck and edge of shoulder.

Review section 4

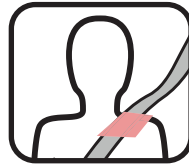

**i** 1 Important



**1 Important**

## **1-B Welcome to the Graco Family!**

Your child's safety depends on you. No car seat can guarantee protection from injury in every situation, but proper use helps reduce the risk of serious injury or death. Even if this car seat seems easy to figure out on your own, you must follow the detailed instructions in this instruction manual to ensure the steps below are performed correctly.



**1 Important**

## **1-C Before You Begin**

### ***Register This Child Restraint***

Please fill out the prepaid registration postcard attached to the seat and mail it in today **or register online at [www.gracobaby.com/carseatregistration](http://www.gracobaby.com/carseatregistration).**

Child restraints could be recalled for safety reasons. You must register this restraint to be reached in a recall. Send your name, address, and the restraint's model number and manufacturing date to:

Graco Children's Products, Inc.

Attn: Customer Service

P.O. Box 169, Elverson, PA 19520-9901

**or register online at [www.gracobaby.com/carseatregistration](http://www.gracobaby.com/carseatregistration)**

or call 1-800-345-4109

For recall information, call the U.S. Government's Vehicle Safety Hotline at

1-888-327-4236

(TTY: 1-800-424-9153), or go to <http://www.NHTSA.gov>.



**1 Important**

For future reference or if you change addresses, record the model name, model number, date of manufacture and purchase date of this car seat on the below. You can find this information either on the registration card if you still have it or on the date label located on the back of the car seat.

**Model Name** \_\_\_\_\_

**Model Number** \_\_\_\_\_

**Date of Manufacture** \_\_\_\_\_

**Date of Purchase** \_\_\_\_\_

### ***If You Need Help***

In the U.S.A, please contact our Customer Service Department with any questions you may have concerning parts, use, or maintenance. When you contact us, please have your product's model number and date of manufacture ready so that we may help you efficiently. These numbers can be found on a sticker on the back side of your car seat.

For additional resources or to get your car seat checked by a child passenger safety technician, please visit the following web sites:

[www.nhtsa.gov](http://www.nhtsa.gov) • [www.seatcheck.org](http://www.seatcheck.org) • [www.safekids.org](http://www.safekids.org)

### ***Certification***

This child restraint meets or exceeds all applicable requirements of Federal motor vehicle safety standard 213 for use in motor vehicles.



This child restraint is NOT certified for aircraft use because aircrafts do not have shoulder belts.

### ***Car Seat's Useful Life***

STOP using this car seat and throw it away 10 years after the date of manufacture. Look for date of manufacture label on back of the car seat.

Graco Children's Products Inc. advises against loaning or passing along a car seat unless you know the complete history of the product. We also advise against purchasing a car seat second hand.

### ***Vehicle Seat Protection***

Protect vehicle seat. Use a car seat mat, towel, or thin blanket under and behind car seat.



1 Important

### *Warm Weather Use*

Car seat parts can get very hot in the sun or warm weather. **To avoid burns, always check before putting child in car seat.**

## **1-D Safety Warnings**

**No car seat can guarantee protection from injury in every situation, but proper use helps reduce the risk of serious injury or death. READ THIS MANUAL CAREFULLY.**

### **! WARNING!**

**Failure to follow these instructions and child restraint's labels can result in child striking the vehicle's interior during a sudden stop or crash.**

**! When forward-facing, children should use the built-in harness system for as long as possible until they reach the maximum forward-facing weight or height for their car seat. At that point, children should ride in a belt-positioning booster seat. A booster is no longer needed once the vehicle seat belt fits properly, typically when they reach 4 feet 9 inches (145 cm) tall and are between ages 8-12. Be sure to check your local and state laws, as well as AAP and NHTSA recommendations, for car seat usage.\***

**! Review your vehicle owner's manual for more information about air bags and car seat use.**

**! If your vehicle does not have a back seat, review your vehicle owner's manual.**

**! Select a suitable location for the car seat in your vehicle.**

**! DO NOT use car seat if it is damaged or missing parts.**

\*Graco Supports the American Academy of Pediatrics and National Highway Traffic Safety Administration's Car Seat Guidelines. Visit [www.gracobaby.com/en-US/safety-information](http://www.gracobaby.com/en-US/safety-information) for information on car seat usage recommendations.

**1 Important**

- ! Always secure car seat with the lower anchor hooks or a vehicle seat belt, when unoccupied. In a crash, an unsecured car seat can injure passengers.**
- ! If car seat is in a crash, it must be replaced. DO NOT use it again! A crash can cause unseen damage and using it again could result in serious injury or death.**
- ! DO NOT use accessories or parts other than those provided by Graco. Their use could alter the performance of the car seat.**
- ! Never leave child unattended, even when sleeping. Child may become tangled in vehicle belt straps and suffocate or strangle.**

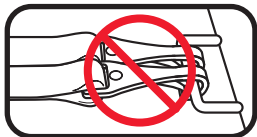

- ! Never attach two lower anchor connectors to one vehicle lower anchor bar unless specifically allowed by the vehicle manufacturer.**



## 2-A Car Seat Features

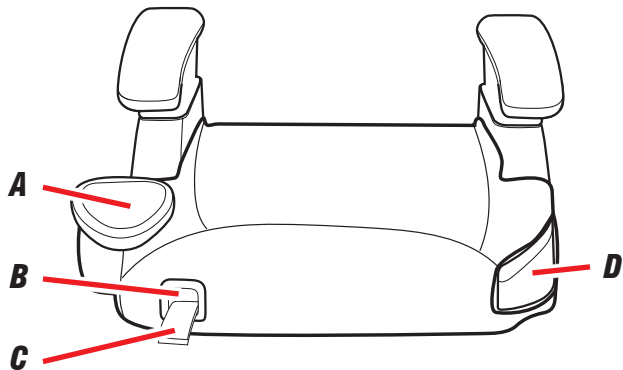

- A** *Cup Holder*
- B** *Lower Anchor Adjuster Button*
- C** *Lower Anchor Adjustment Straps*
- D** *Storage Compartment*

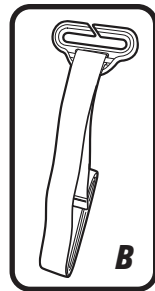
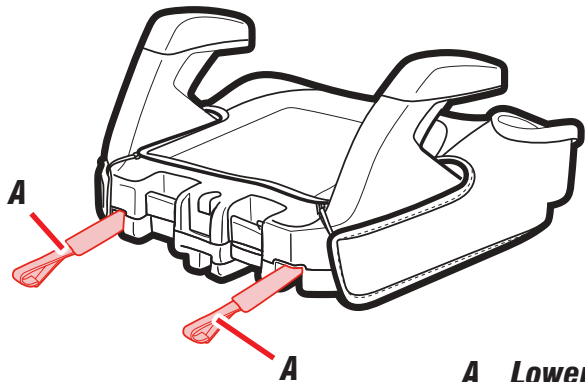

- A** Lower Anchor Connectors
- B** Belt Positioning Clip (Inset)

## 3-A Booster Use

***Booster Use Without Back: 40-100 lb (18.1-45 kg) 43-57 in. (110.1-145 cm) at least 4 years old***

- Place car seat forward-facing in the vehicle back seat.
- Make sure vehicle seat's lap belt is adjusted snugly and lays low on the child's hip and is routed in front of the armrest in the booster's belt path.
- Vehicle belts **MUST** lie flat against child and **MUST NOT** be twisted.
- Vehicle seat's shoulder belt is adjusted snugly and should lie between child's neck and edge of shoulder.
- **DO NOT** position vehicle shoulder belt under the child's arm or back.



***Vehicle Lap/Shoulder Belt***



**3 Booster**



### 3 Booster

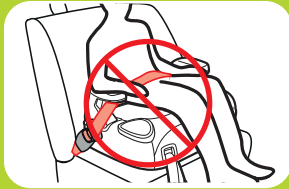

***Never Use a Vehicle Lap-Only Belt Across Front of Child***



- **Never** use a vehicle lap-only belt across front of child.
- **DO NOT** allow child to slouch or slide down in the booster seat.
- **DO NOT** position vehicle belt over top of armrests.
- The front of booster seat **MUST NOT** hang over front of vehicle seat.
- If child will not keep vehicle belt properly positioned, **DO NOT** use this booster seat. Use a different car seat.

When forward-facing, children should use the built-in harness system for as long as possible until they reach the maximum forward-facing weight or height for their car seat. At that point, children should ride in a belt-positioning booster seat. A booster is no longer needed once the vehicle seat belt fits properly, typically when they reach 4 feet 9 inches (145 cm) tall and are between ages 8-12. Be sure to check your local and state laws, as well as AAP and NHTSA recommendations, for car seat usage.

## 3-B Install Backless Booster

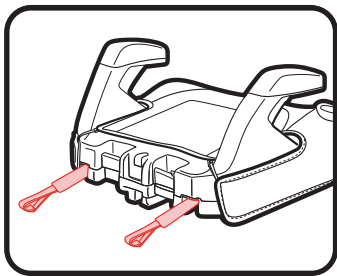

Graco allows the securing of the car seat with the lower anchor attachment in the booster mode. The child still **MUST BE SECURED** with the vehicle lap/shoulder seat belt. The lower anchor attachment can be used in the booster mode regardless of the weight of the child up to 100 lb (45 kg).

Verify the following before using the lower anchor attachment in the booster mode:

- The lower anchor attachment **DOES NOT** interfere with any vehicle seat belts or buckles.

If the lower anchor attachment interferes with the vehicle seat belts or if the chosen seating position does not have lower anchors, you **MUST** store the lower anchor connector. Always secure car seat with the lower anchor connector or a vehicle seat belt, even when unoccupied. In a crash, an unsecured car seat can injure passengers.

3 Booster  

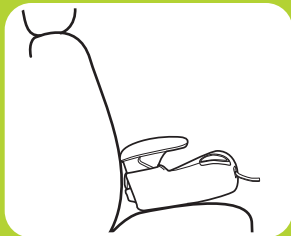



**1. Place the Booster Seat Forward-Facing in the Back Seat of Vehicle**

Place forward-facing on a vehicle seat that has a lap/shoulder seat belt. The base should sit as flat as possible on the vehicle seat.

**See section 4 to secure your child.**

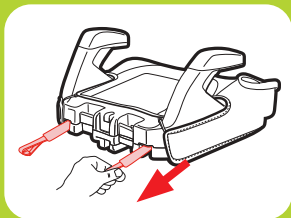
***If Using the Lower Anchors***



**2. Extend the Lower Anchor Straps.**

For easier installation, extend the lower anchor straps to their maximum length by pressing the button on the front of the base and pulling out on the straps.

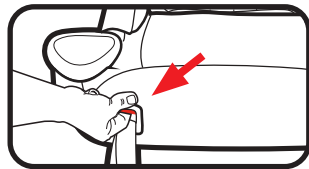

### **3. Attach Lower Anchor Connectors to Vehicle's Lower Anchor Bars.**

Lower Anchor straps should not be twisted.

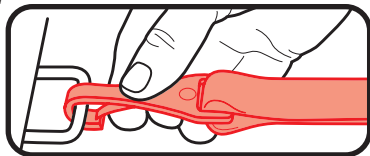

### **4. Tighten the Lower Anchor Straps**

Remove all the slack from the lower anchor straps by pushing on the booster and pulling straps on front of the booster.

Depending on your vehicle, you may need to align the lower connectors with the slots in the base to get a good install.

The bottom of the seat should sit as flat as possible on the vehicle seat.

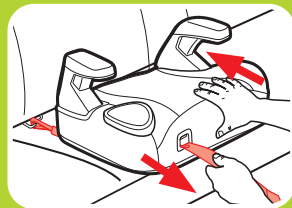
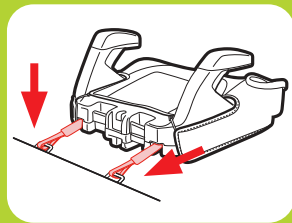

  
3 Booster

## 4-A Securing Child Backless Booster

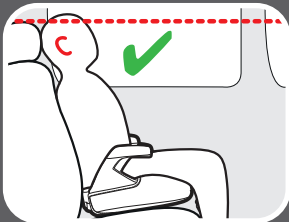

### **! WARNING!**

**Use only the vehicle lap and shoulder belt system when restraining the child in the booster seat.**

#### **1. Place Child In Seat**

Have your child sit in the booster seat, with his/her back flat against the back of the vehicle seat.

#### **2. Ears Must Be Below the Top of the Vehicle Seat Back or Headrest.**



### **3. Buckle the Vehicle Lap/Shoulder Seat Belt**

Be sure the lap portion of the vehicle seat belt goes in front of both armrests and the shoulder belt goes under the armrest on the buckle side.

Be sure the lap portion of the vehicle seat belt lies low across your child's hips.

Be sure the shoulder belt lies across your child's shoulders, between the neck and edge of shoulder.

**You may need to use the belt positioning clip to help get a good fit. See "Using Belt Positioning Clip"**

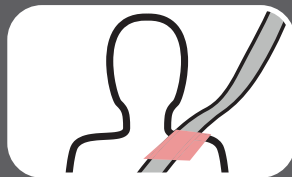
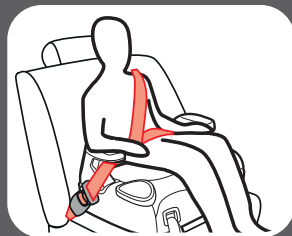

*Is Everything Correct?*

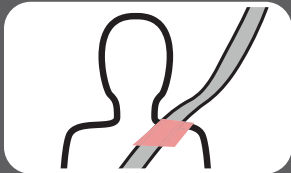

***Never Use Lap Belt Only***

***Lap Belt in Front of Armrest and Lies Low Across Hips and Thighs***

***Shoulder Belt Lies On the Shoulder, Between the Neck and Edge of Shoulders***

## Using Belt Positioning Clip

### 1. Make Sure Vehicle's Seat Shoulder Belt Lays in the Red Zone As Shown

If the vehicle's seat shoulder belt lays outside this zone, you **MUST** use the belt positioning clip. **DO NOT** use the belt positioning clip if the shoulder belt is in the red zone.

### 2. Attach Belt Positioning Clip

The shoulder belt positioning clip **MUST** be attached to the slot on the bottom of the base. Insert the loop end of strap through the slot on bottom of seat exactly where shown.



### 3. Push Clip and Strap Through Loop

Pass the clip and the strap through the loop end as shown and pull strap up.

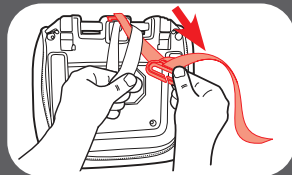
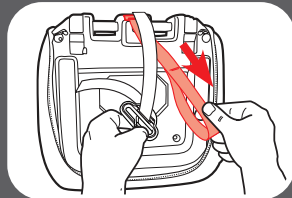
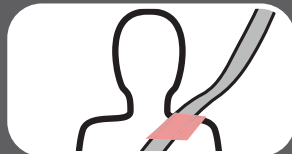

## 4 Securing Child

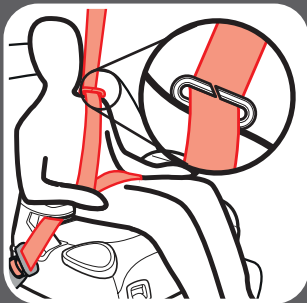
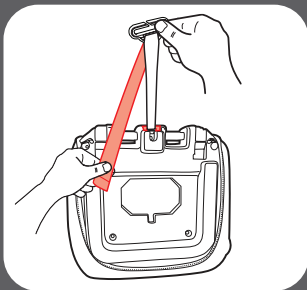

### **4. Free End of Strap Should Face Front of Seat**

### **5. Place Child in Seat, Buckle Child In Seat and Attach Belt Positioning Clip**

With child's back flat against the back of the vehicle seat, buckle child in. Then slide the clip onto the vehicle's seat shoulder belt as shown.

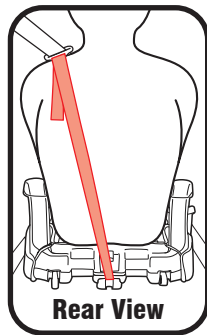

## 6. Adjust the Belt Positioning Clip to Fit Your Child

Lengthen or shorten the belt length as shown.

Clip should fit right at the top of shoulder as shown.

Be sure the lap portion of the vehicle seat belt lies low across your child's hips.

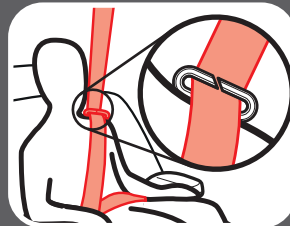
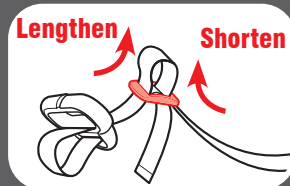

## 5 Accessories *(on select models)*

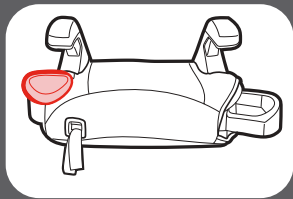

***Cup Holder***

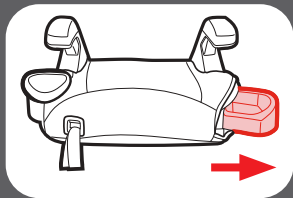

***Storage Compartment***

## 6-A How to Remove Lower Anchor Connectors

### ***Lower Anchor Connector***

Push release button up on front of booster and pull slightly away from seat.

Press in on the hook's spring. Push hook in, lift hook up, twist and pull out away from anchor point.

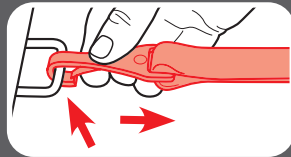
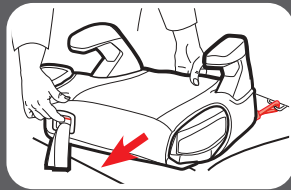

6 Vehicle  
Information



## 6-B Choosing Vehicle Seat Location

*Review your vehicle's owner manual for Seating Locations*

***The best seating location for this car seat is one that:***

- Is recommended by your vehicle owner's manual, and
- Results in a secure installation of this car seat

In the event there is no available back seat and / or you have no other option, the National Highway Traffic Safety Administration (NHTSA) recommends that you take the following steps:

- Ensure the child is properly restrained according to their age and size
- Move the seat as far back as possible
- Make sure the child is not leaning out of position, such as leaning forward into the deployment path of the air bag
- Set the air bag ON-OFF switch, if available, to the OFF position





## 6-C Unsafe Vehicle Seat Location

Never install this car seat in any of the following vehicle seating locations:



rear-facing or side-facing  
vehicle seats



booster mode with vehicle  
lap belt only seat belt



## 6-D Vehicle Seat Belts

*Review your vehicle's owner manual for vehicle seat belt use*

### *Vehicle Seat Belt Terms*

#### **Retractor**

A device that winds up the unused vehicle seat belt. It is often hidden inside the panels on the walls of the vehicle or in the vehicle seatback.

#### **Latch Plate**

The male end of the seat belt with the silver tongue.

#### **Seat Bight**

The crease where the vehicle seat back and seat bottom meet.

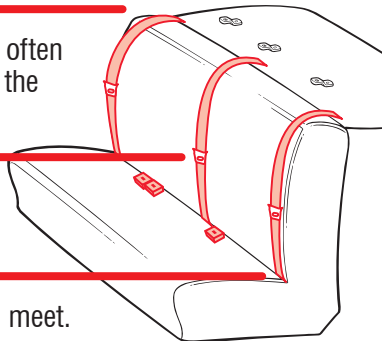



## Identify Your Seat Belt Type

There is one type of vehicle seat belt that can be used with this car seat:

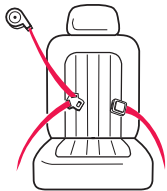

**Lap/Shoulder Belt** 3 connection points.  
Can be used in all car seats modes of use.



Belts Forward of the Seat  
Bight:  
Some vehicles you may not  
get a secure fit. Read both  
your vehicle and car seat  
manuals.

The following types of vehicle seat belts **CANNOT** be used safely with this car seat:



Lap Belt Only 2  
connection points.



Lap Belt with Motorized  
Shoulder Belt



Lap Belt or Shoulder  
Belt Mounted on Door

## 7-A Cleaning Seat Pad

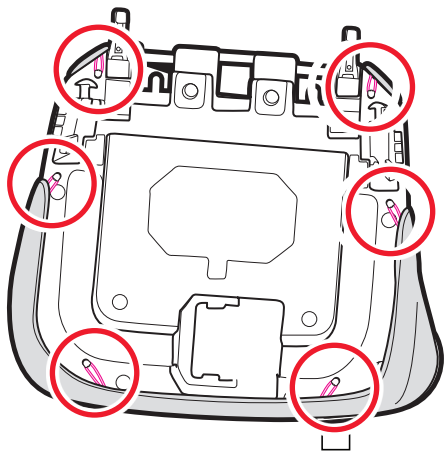

Refer to seat pad care tag for washing instructions.

### ***Seat Cover***

Remove elastic loops and hooks from seat as shown.

Clean with a damp sponge using mild soap and cool water. If needed, seat cover may be removed for cleaning. Machine wash cover in cold water on delicate cycle and drip-dry. **DO NOT USE BLEACH.**

To put the seat cover back on, re-attach pad, loops and hooks.

## 7-B Cleaning Lower Anchor Straps

Surface wash only with mild soap and damp cloth. **DO NOT IMMERSE THE LOWER ANCHOR STRAPS IN WATER** Doing so may weaken the straps.

If lower anchor straps are frayed or heavily soiled, contact Customer Service at [www.gracobaby.com](http://www.gracobaby.com) or 1-800-345-4109.

# Notes

# Notes

## Replacement Parts

To purchase parts or accessories in the United States,  
please contact us at the following:

**[www.gracobaby.com](http://www.gracobaby.com)**

or

**1-800-345-4109**



Store instruction manual in  
the slot with the instruction  
book icon as shown.

